

VISY-X

VISY-Command GUI - Printer Retrofit



Version: 1
Edition: 2022-03
Art. no.: 350361

Table of contents

1	Overview.....	1
2	Scope of Delivery	1
3	Installation	2
3.1	VISY-Command GUI for Retrofitting.....	2
3.2	Preparations.....	3
3.3	Display Installation	8
3.4	Installation of the new Housing Door	10
3.5	Cabling and Fixing	11
4	List of Figures	16

© Copyright:



Reproduction and translation are permitted only with the written consent of the FAFNIR GmbH. The FAFNIR GmbH reserves the right to carry out product alterations without prior notice.

1 Overview

VISY-Command GUI is an evaluation unit with display to show current tank data, delivery data and various alarms that are recorded by the **VISY-X system**. It can be retrofit with an additional printer.

This manual describes how to retrofit a printer to the **VISY-Command GUI**.

2 Scope of Delivery

	<p>Housing door with built-in printer</p> <p>Pre-cabled for:</p> <ul style="list-style-type: none"> • Connection to the display • Connection to the extension interface • Connection to the 12 V power supply (display) • Connection to the 5 V power supply (printer) • Grounding (display, printer, device housing)
	<p>5V_{DC} Power Supply Unit</p>
	<p>Power Supply Cable</p>
	<p>Cable ties</p>

3 Installation

3.1 VISY-Command GUI for Retrofitting



Figure 1: VISY-Command GUI

3.2 Preparations



Disconnect the VISY-Command GUI from power supply before opening the housing.

- (1) Open VISY-Command GUI with the housing key



Figure 2: VISY-Command 4 GUI, inner view

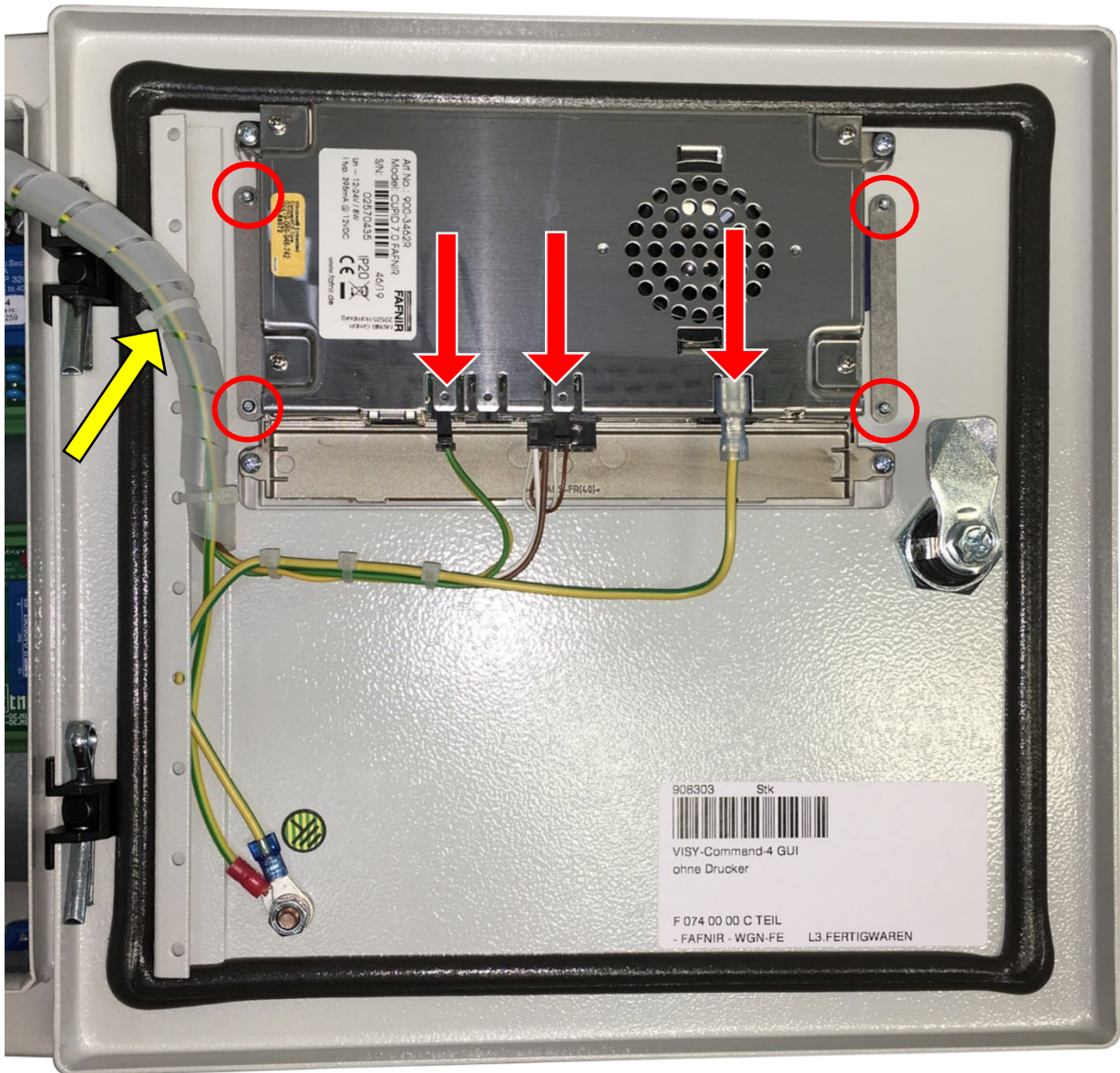

Figure 3: VISY-Command GUI housing door, back

- (2) Disconnect all cables from the display (red arrows)
- (3) Remove the display from the housing door (red circles).
A TORX screwdriver size T6 is required for this.
- (4) Remove the cable spiral (yellow arrow)

- (5) Remove the spring clip from the power supply (12 VDC) with a flat head screwdriver to be able to remove the power supply unit



Figure 4: 12 V Power supply unit, spring clip

- (6) Remove the cables from the VI-4 board
- Power supply cables (12 V site) to the display
 - Grounding cable to the extension interface (yellow)
 - Ribbon cable at the VI-4 board

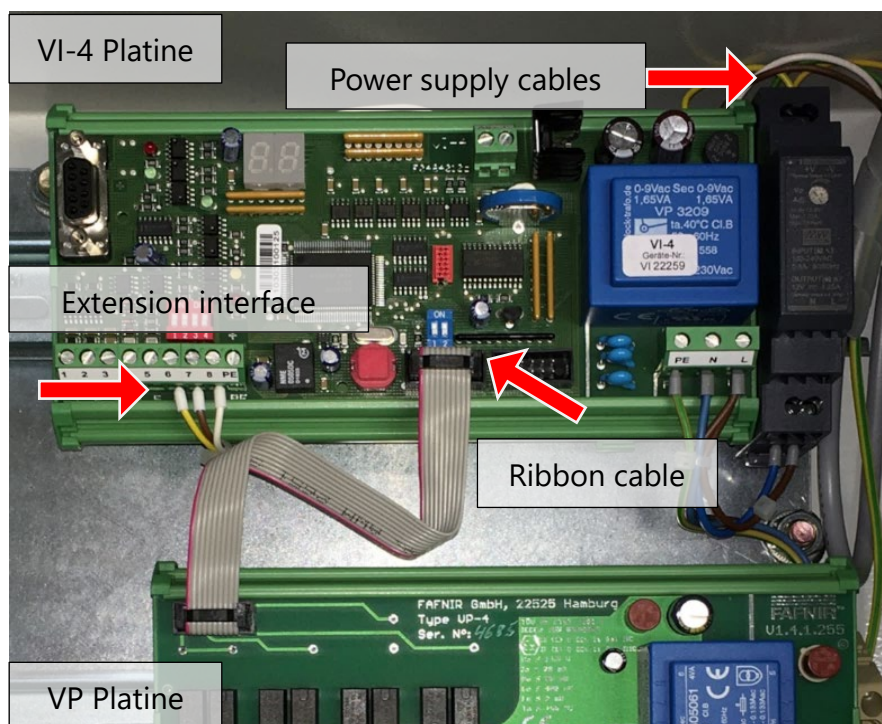

Figure 5: VI-4 board, cabling

- (7) Remove the grounding cable from the side wall of the housing



Figure 6: VISY-Command GUI, right side wall

- (8) Using a flat-head screwdriver, press the two VI-4 board holders (red arrows) down to be able to lever the board from the DIN rail.



Figure 7: VI-4 Board, fixing

- (9) Turn the VI-4 board forward and cut the cable tie which fixes the cables to the VI-4 board.

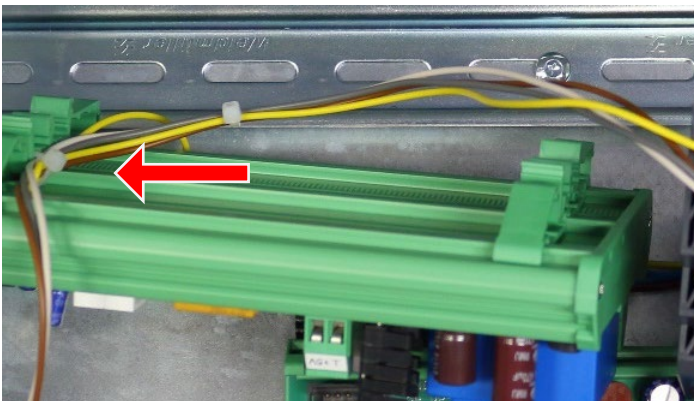

Figure 8: VI-4 board, cable tie

- (10) Remove the grounding cable from the VI-4 board and the housing wall
- (11) Remove the 230 V_{AC} power supply cable from the VI-4 board, from the 12V_{DC} power supply unit, from the VP board and from the power supply terminal (red circles)

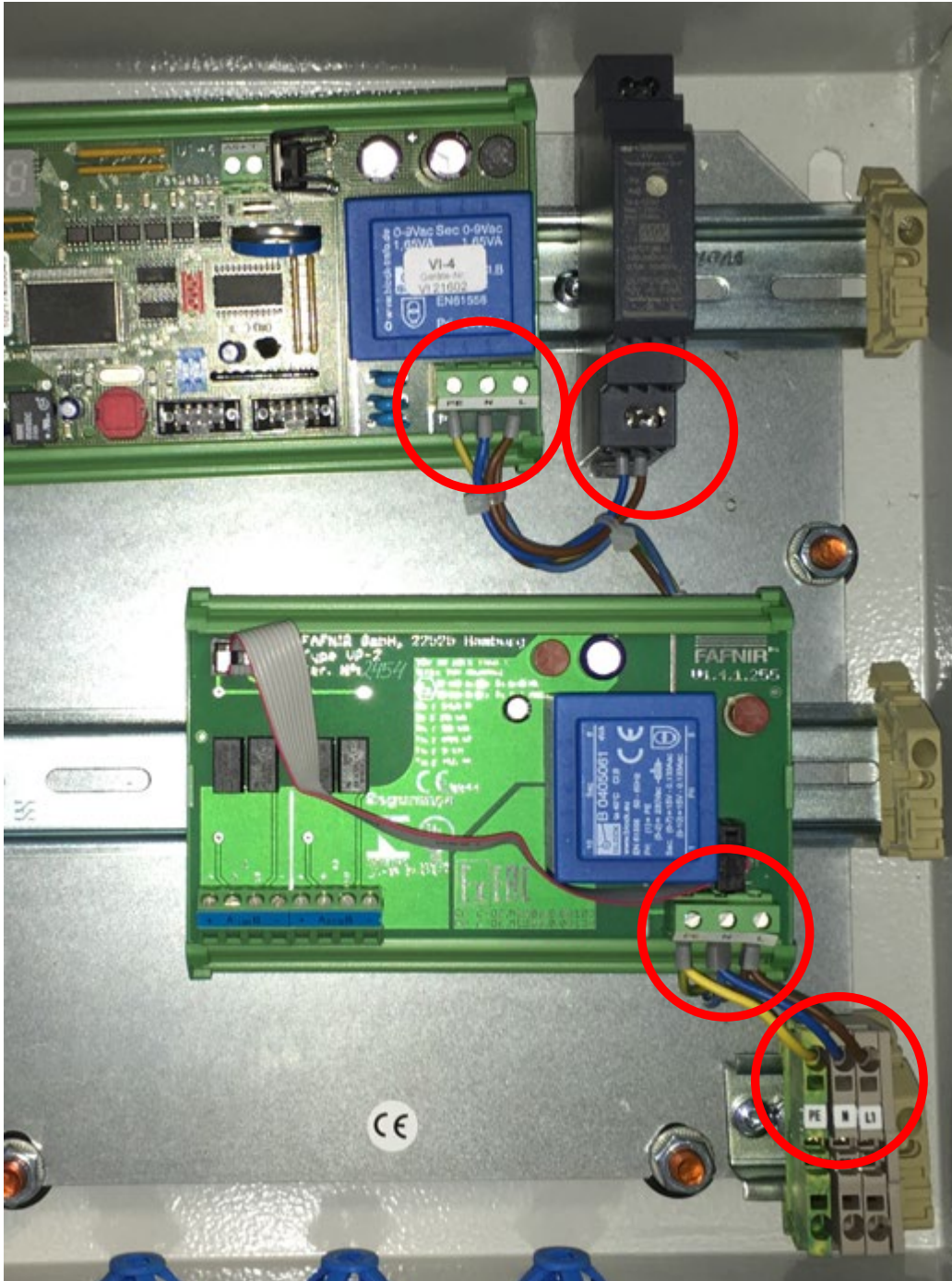

Figure 9: Power supply cabling

- (12) Remove the screw nuts from the door hinges on the housing inside and remove the housing door

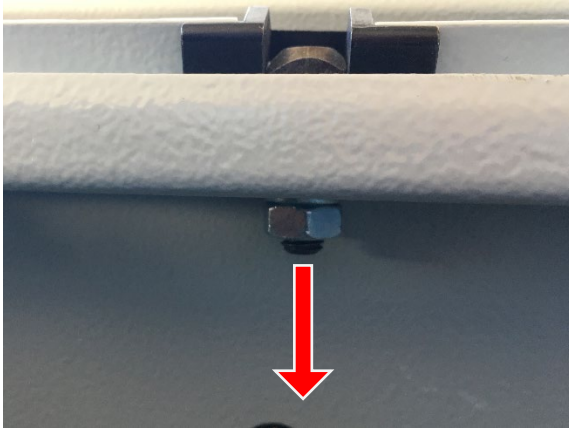

Figure 10: Housing door, fixing

3.3 Display Installation

- (1) Lay the display face down on a table. Make sure that it is protected against damages.
- (2) Place the new housing door over the display so that the display's mounting holes are visible.
- (3) Fix the display with the 2 rails (red rectangles) and the 4 screws to the housing door.



Figure 11: Display, fixing

- (4) Plug the cables (red arrows) in the display. The cable plugs have an individual design and are therefore non-interchangeable.

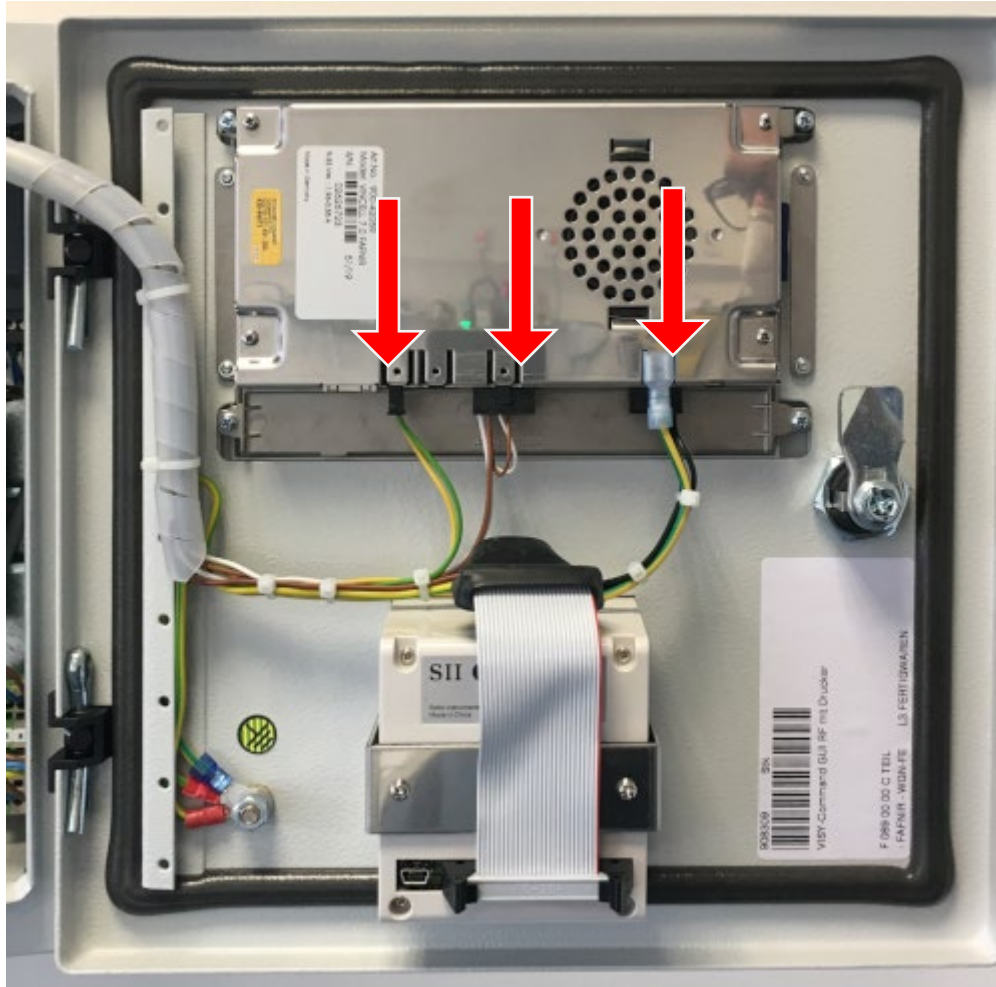

Figure 12: Display, cabling

3.4 Installation of the new Housing Door

- (1) Plug the threads of the door hinges in the openings of the housing

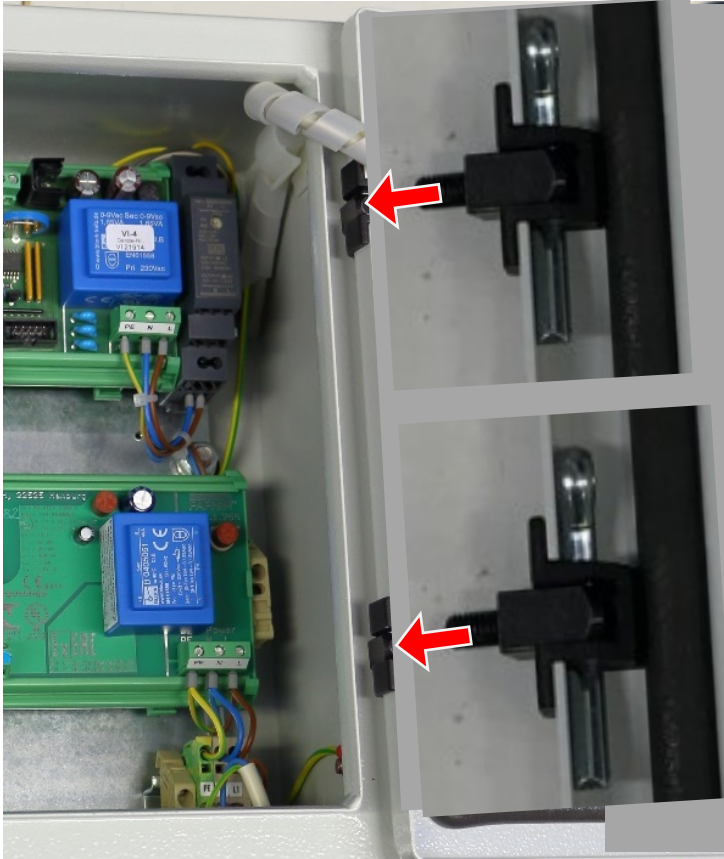

Figure 13: Installation of the new housing door

- (2) Fix the housing door with the washers and the screw nuts to the housing

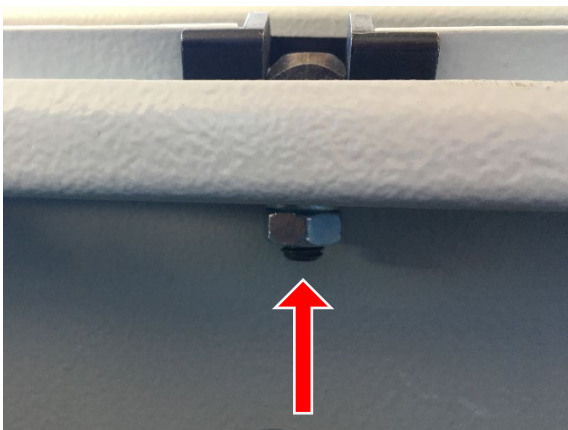

Figure 14: Housing door, fixing

3.5 Cabling and Fixing

- (1) Lead the cable harness inside the housing interior
- (2) Rewrap the cable harness with the cable spiral
- (3) Lay the cables to the VI-4 extension interface (yellow, white, brown) underneath the VI-4 board and fasten them with a cable tie to the underside of the board holders

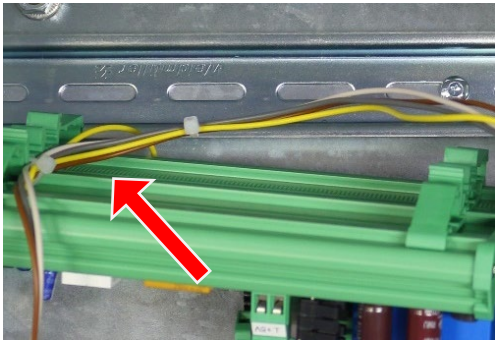

Figure 15: VI-4 board, cable fixing

- (4) Press the VI-4 board on the DIN rail and let it snap in
- (5) Connect the cables to the VI-4 board according to following table:

Terminal	Assignment
VI-4 Extension interface	White = 8 Brown = 7 Yellow= 6



Abbildung 1: VI-4 Platine, Verkabelung

- (6) Place the 5 V power supply unit beside the 12 V power supply unit and connect the cables according to the following table:

Terminal	Assignment
12 V Power supply unit	Green = V+ Yellow = V-
5 V Power supply unit	Brown = V+ White = V-

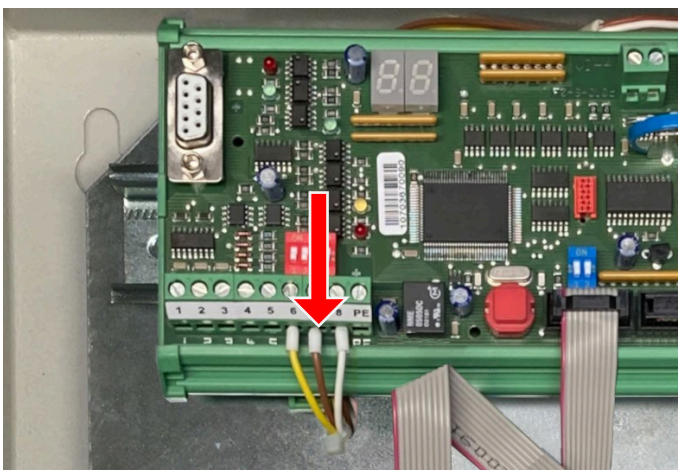

Figure 16: Power supply units, cabling

- (7) Connect the power supply cables (yellow/green, blue, brown) to the 230 V power supply unit, to the 12 V power supply unit, to the 12 V power supply unit and to the power supply terminal (red circles) according to the following table:

Terminal	Assignment
230 V power supply unit and Power supply terminal	Yellow - green = PE Blue = N Brown = L
12 V power supply unit	Blue = N Brown = L
5 V power supply unit	Blue = N Brown = L



Figure 17: Power supply cabling



Figure 18: Power supply terminal

- (8) Press both power supply units on the DIN rail and to fix the power supply units , push the spring clips with the flat head screwdriver in the DIN rail.



Abbildung 2: Fixierung Netzteile

- (9) Connect the grounding cable again to the side wall of the housing



Figure 19: VISY-Command GUI, right side wall

- (10) Connect the VI-4 board and the VP board again with the ribbon cable
(11) Installation is completed, the result should look like the following figure.



The cables must all be routed in such a way that none can fall into the Ex-approved area of the VP board.

(12) Result



Figure 20: VISY-Command GUI with printer, inside view

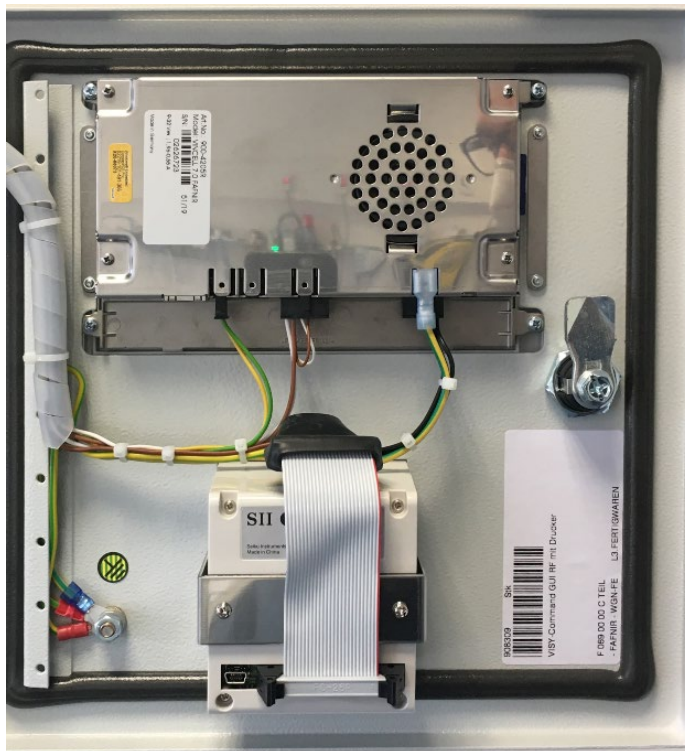

Figure 21: VISY-Command GUI with printer, housing door

4 List of Figures

Figure 1: VISY-Command GUI	2
Figure 2: VISY-Command 4 GUI, inner view	3
Figure 3: VISY-Command GUI housing door, back	4
Figure 4: 12 V Power supply unit, spring clip.....	5
Figure 5: VI-4 board, cabling.....	5
Figure 6: VISY-Command GUI, right side wall	6
Figure 7: VI-4 Board, fixing	6
Figure 8: VI-4 board, cable tie	6
Figure 9: Power supply cabling	7
Figure 10: Housing door, fixing	8
Figure 11: Display, fixing.....	8
Figure 12: Display, cabling	9
Figure 13: Installation of the new housing door	10
Figure 14: Housing door, fixing	10
Figure 15: VI-4 board, cable fixing.....	11
Figure 16: Power supply units, cabling.....	12
Figure 17: Power supply cabling.....	13
Figure 18: Power supply terminal.....	13
Figure 19: VISY-Command GUI, right side wall.....	14
Figure 20: VISY-Command GUI with printer, inside view	15
Figure 21: VISY-Command GUI with printer, housing door	15

Blank page



FAFNIR GmbH
Schnackenburgallee 149 c
22525 Hamburg, Germany
T: +49 / 40 / 39 82 07-0
E-mail: info@fafnir.com
Web: www.fafnir.com
